

Parts List			
ITEM	PART No.	TITLE	e-Sea WebLink
1	BB8585	USB-A 50W Male wFlange Intervention	<a href="https://e-sea.bluelogic.no/main.aspx?page=article&amp;artno=BB8585">https://e-sea.bluelogic.no/main.aspx?page=article&amp;artno=BB8585</a>
2	BB2428	USB-A 50W Flat Flange Mount Inductive Connector Interv Sec	<a href="https://e-sea.bluelogic.no/main.aspx?page=article&amp;artno=BB2428">https://e-sea.bluelogic.no/main.aspx?page=article&amp;artno=BB2428</a>
3	BB2426	USB-A 50W Flat Flange Mount Inductive Connector Interv Pri	<a href="https://e-sea.bluelogic.no/main.aspx?page=article&amp;artno=BB2426">https://e-sea.bluelogic.no/main.aspx?page=article&amp;artno=BB2426</a>
4	BB2340	Protection Cap Assy 50W	on request
5	BB2306	USB-A 50W Female Flange Mount Inductive Connector Interv	<a href="https://e-sea.bluelogic.no/main.aspx?page=article&amp;artno=BB2306">https://e-sea.bluelogic.no/main.aspx?page=article&amp;artno=BB2306</a>
6	BB2288	USB-A 50W Primary Female w/Handle	on request
7	BB2278	USB-A 50W Secondary Male w/Handle Int. Alt. Plastic Ring	<a href="https://e-sea.bluelogic.no/main.aspx?page=article&amp;artno=BB2278">https://e-sea.bluelogic.no/main.aspx?page=article&amp;artno=BB2278</a>

### INTERVENTION PROGRAM

#### PRIMARY

#### SECONDARY

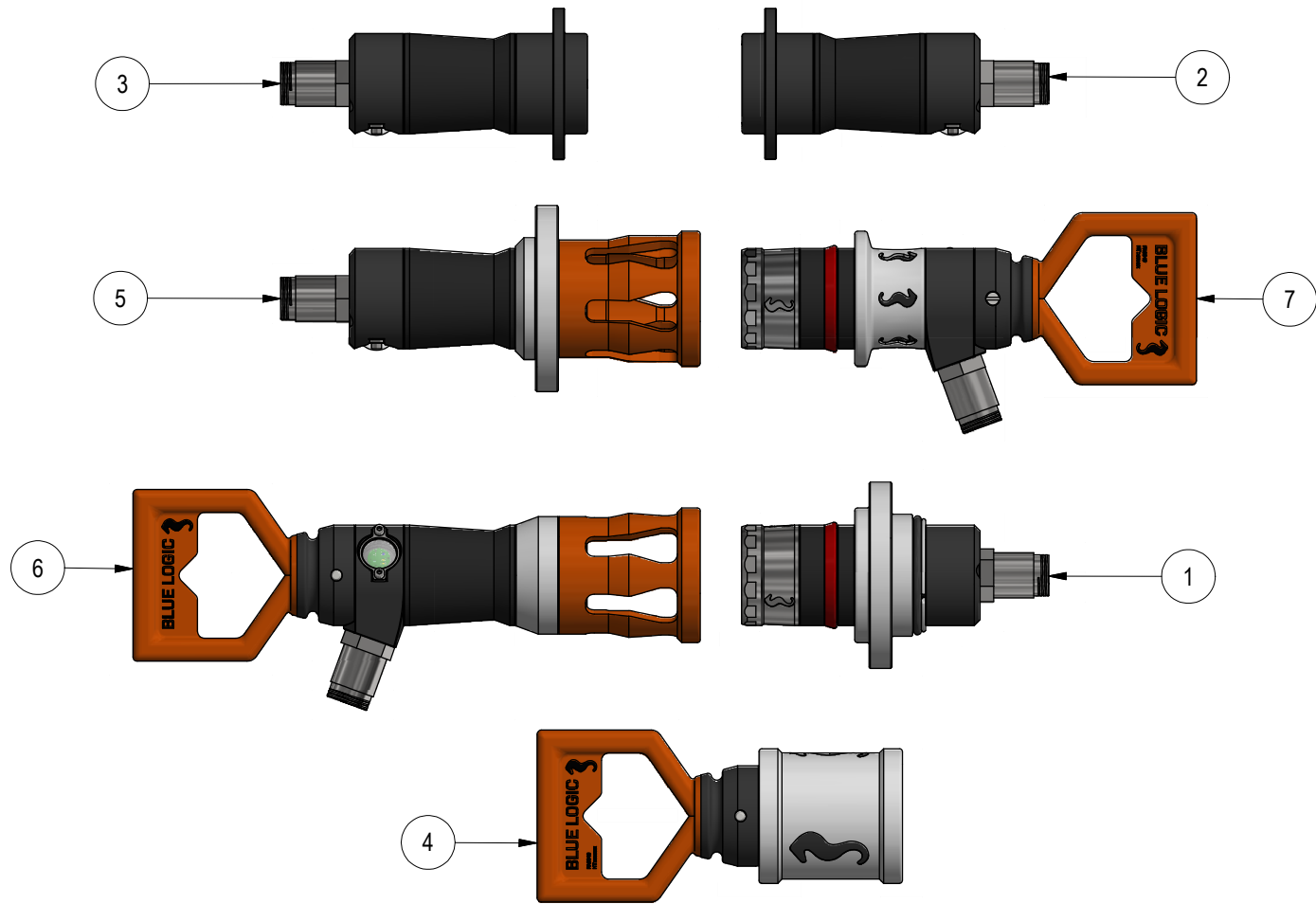

NOTE: 1

#### ADDITIONAL INFORMATION:

The Subsea USB 50W system is based on the Unplugged inductive technology for transfer of electrical power and communication subsea. The 50W connector system is part of the complete "Subsea-USB" system covering power range from 50W to 3000W with communication speeds up to 1 Gbit/s.

In general, each Inductive system consists of a Primary (TX) and a Secondary (RX) side installed in a ROV friendly housing. The power is transferred from the Primary side to the Secondary side whilst communication is operated in full duplex.

The Subsea-USB Connectors can be configured in the following alternatives:

1. Manually operated by hand
2. ROV operated.
3. Bulkhead piggy backed on other equipment.
4. Combined with hydraulic connector thus allowing for electrical power, communication and hydraulic connections to be made up using the same connector assembly

Input voltage 22-50VDC at primary side and 24VDC voltage output on the secondary side. The inductive coils are galvanically isolated from each other and can be looked at as a 1 to 1 transformer. The 50W system has 13-pin connector where both RS232, RS485 (230kbps), Ethernet (80Mbps) and Power are available on both sides. Feasible to have RS232 connected on the Secondary side (tool side) and RS485 connected on the primary side (ROV side). Most systems rated to 3000m water depth.

The system can be delivered in the following material types: Aluminium or Super duplex. It is recommended to always include the connector in the CP protection system and make sure it is in galvanic contact. Aluminium is designed for short-term (intervention) use. Super Duplex version has a design life of 3-5 years.

Parts List			
ITEM	PART No.	TITLE	e-Sea WebLink
1	BB9047	USB-A 50W Primary Test Unit	<a href="https://e-sea.bluelogic.no/main.aspx?page=article&amp;artno=BB9047">https://e-sea.bluelogic.no/main.aspx?page=article&amp;artno=BB9047</a>
2	BB9046	USB-A 50W Secondary Test Unit	<a href="https://e-sea.bluelogic.no/main.aspx?page=article&amp;artno=BB9046">https://e-sea.bluelogic.no/main.aspx?page=article&amp;artno=BB9046</a>
3	BB5385	USB-A 50W Female Flange Mount Inductive Conn. Long-term	on request
4	BB2719	USB-A 50W Male wFlange Long-term	<a href="http://e-sea.bluelogic.no/main.aspx?page=article&amp;artno=BB2719">http://e-sea.bluelogic.no/main.aspx?page=article&amp;artno=BB2719</a>
5	BB2718	USB-A 50W Secondary Female w/Handle Perm	on request
6	BB2265	USB-A 50W Secondary Male w/Handle Long Term Use	<a href="http://e-sea.bluelogic.no/main.aspx?page=article&amp;artno=BB2265">http://e-sea.bluelogic.no/main.aspx?page=article&amp;artno=BB2265</a>
7	BB8587	USB-A 50W Female Flange Mount Inductive Conn. Long-term	<a href="https://e-sea.bluelogic.no/main.aspx?page=article&amp;artno=BB8587">https://e-sea.bluelogic.no/main.aspx?page=article&amp;artno=BB8587</a>

### LONG-TERM PROGRAM

#### PRIMARY

#### SECONDARY

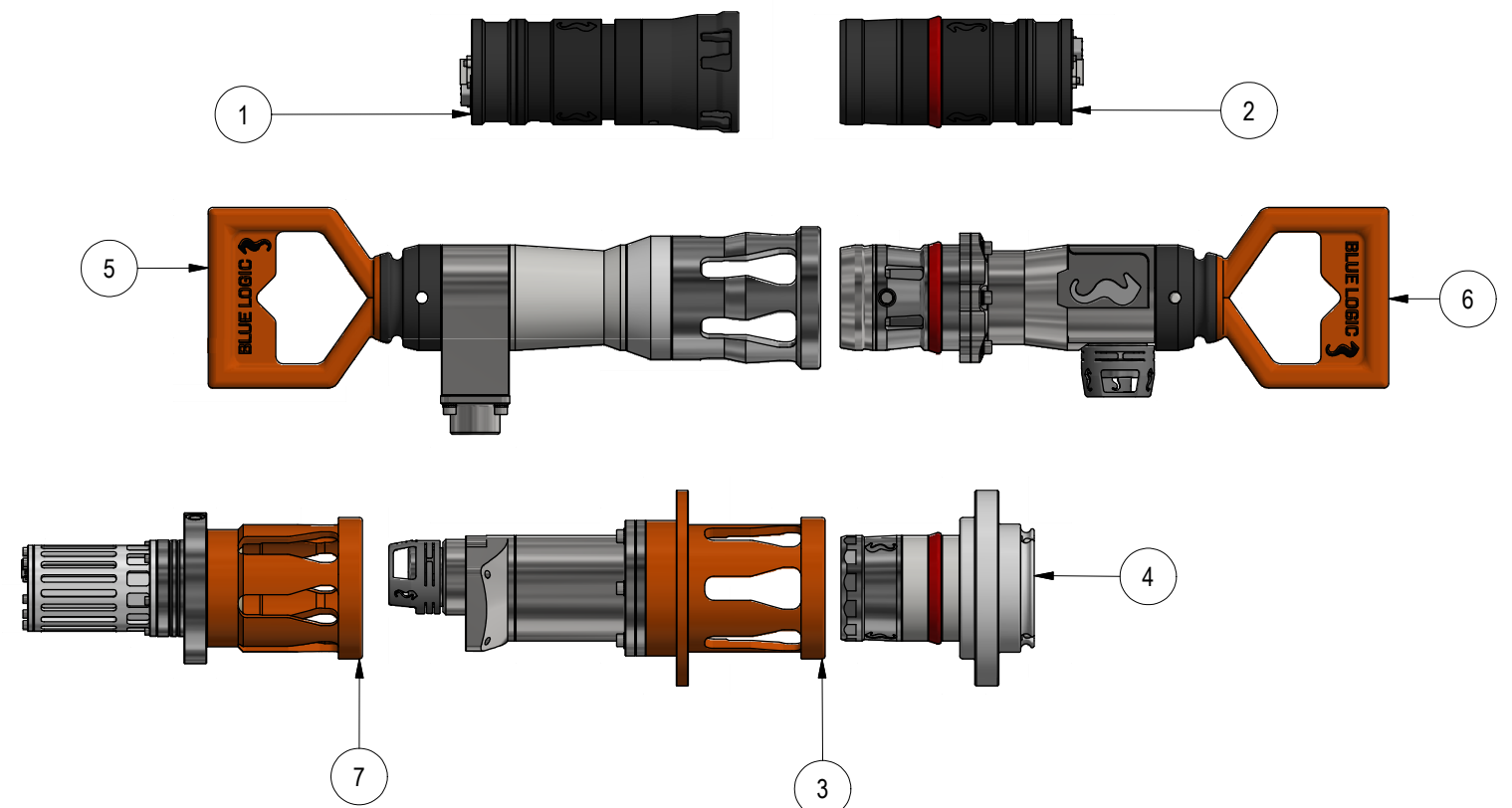

FOR INFORMATION ONLY

Rev.	Date	Reason for issue	Revision change	WTJ	LGH	HSE
01	15.2.2024	3-IFI (Issued for Information)				
				Made	Chk'd	Appr.



Dwg Scale:	NTS
Dwg Proj:	
Dwg Format:	A3

Drawing title:	USB-A 50W Program Gen1
Drawing number:	BB2040
Rev.	01